

North Felixstowe Garden Neighbourhood & Leisure Centre

Anonymous Public Survey Summary – Nov 2024

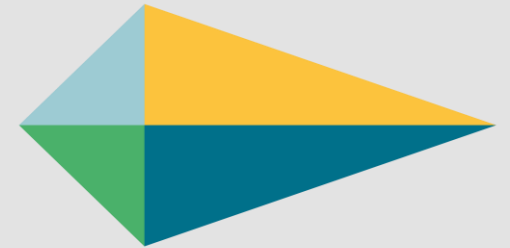

EASTSUFFOLK
COUNCIL

The North Felixstowe Garden Neighbourhood public consultation held on the 13th of August included an anonymous public survey which ran for six weeks in August and September 2024.

More than 500 people responded to the survey which sought opinion specific aspects of the masterplan, in particular:

- Public Open Space
- Active Travel and Connectivity
- Placemaking and Identity
- Sustainability

The survey attempted to ground the questions with some background information to highlight what we were looking for feedback on and to direct respondents to the information prepared for the public event we have included this in the summary for completeness.

Thank you to everyone who took part in the survey.



Q1. Postcode

99% of people who answered this question live within the IP11 postcode area.

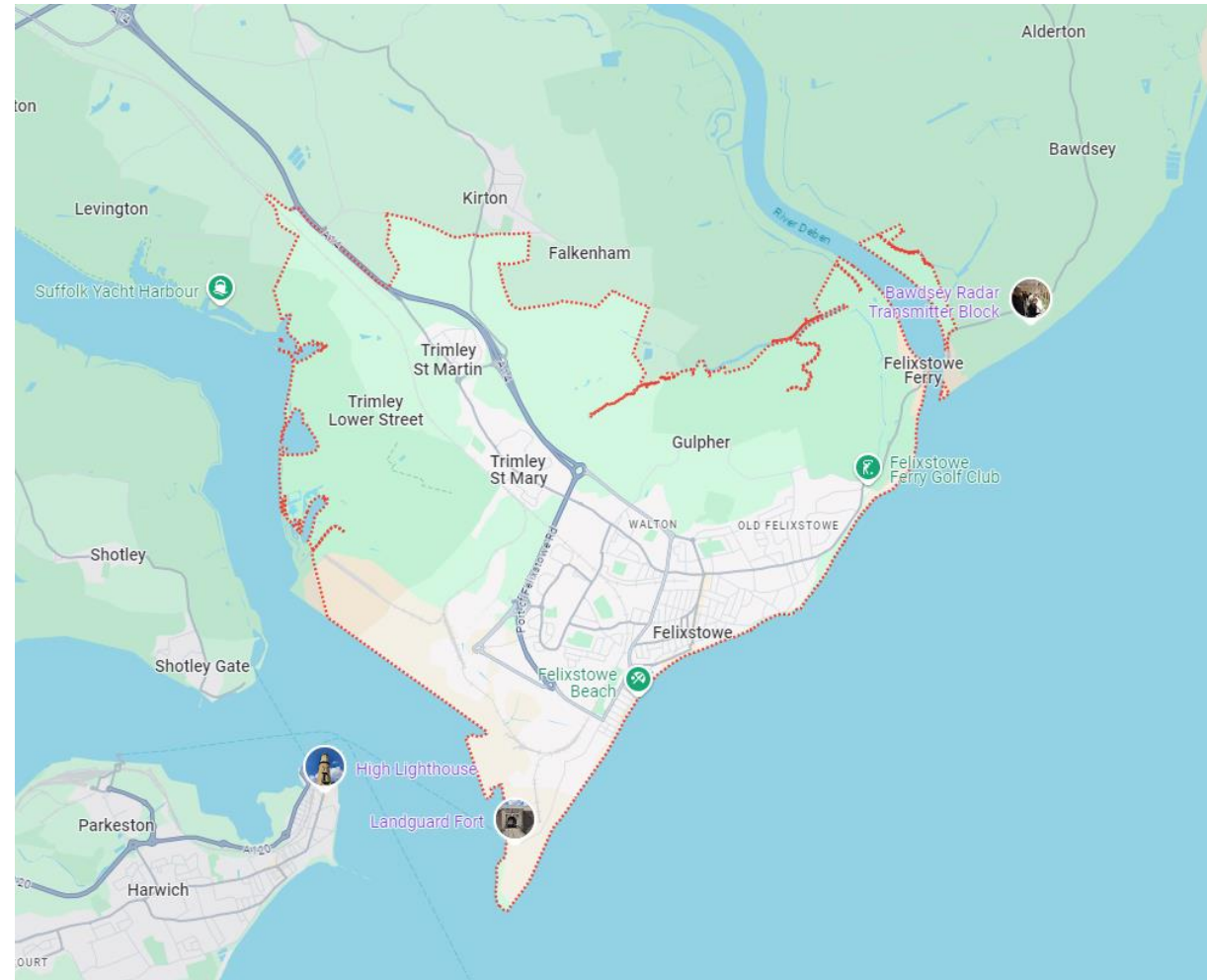

IP 11 postcode area

Q2.Age

Answered: 499 Skipped: 5

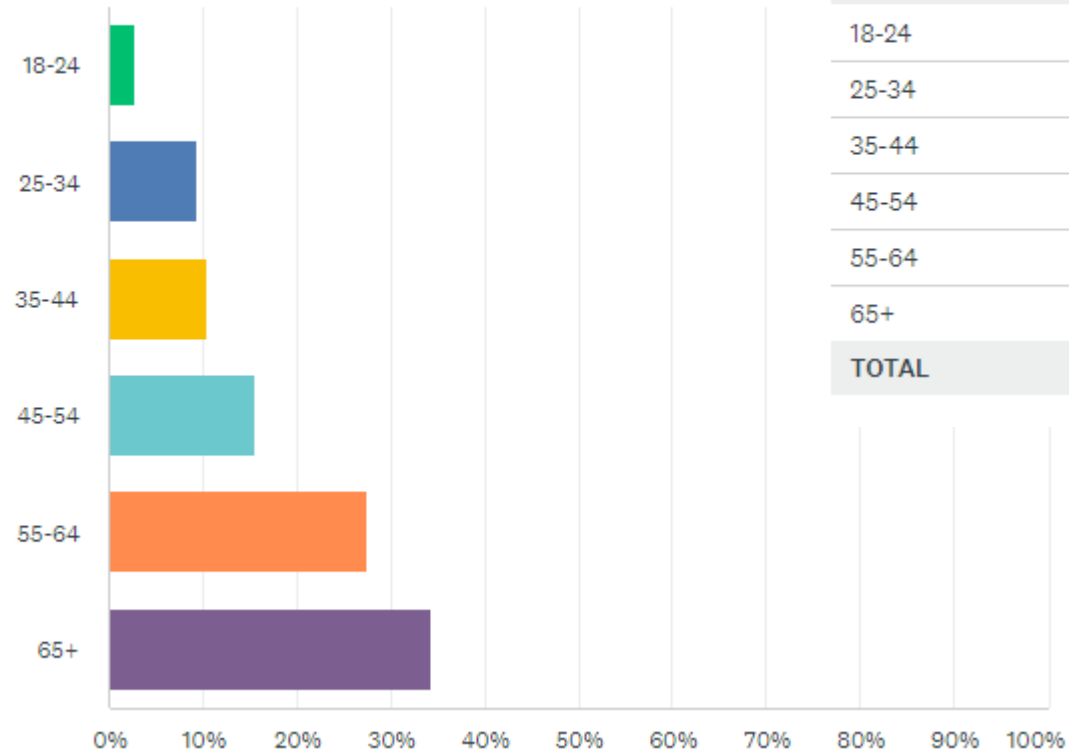

ANSWER CHOICES	RESPONSES		
18-24	2.81%	(5)*	14
25-34	9.42%	(10.3)	47
35-44	10.42%	(10.0)	52
45-54	15.63%	(12.8)	78
55-64	27.45%	(15.3)	137
65+	34.27%	(24.3)	171
TOTAL			499

(Felixstowe & Trimleys demographics in brackets)
*approximate due to different age brackets

Q3. How did you hear about the event today?

Answered: 501 Skipped: 3

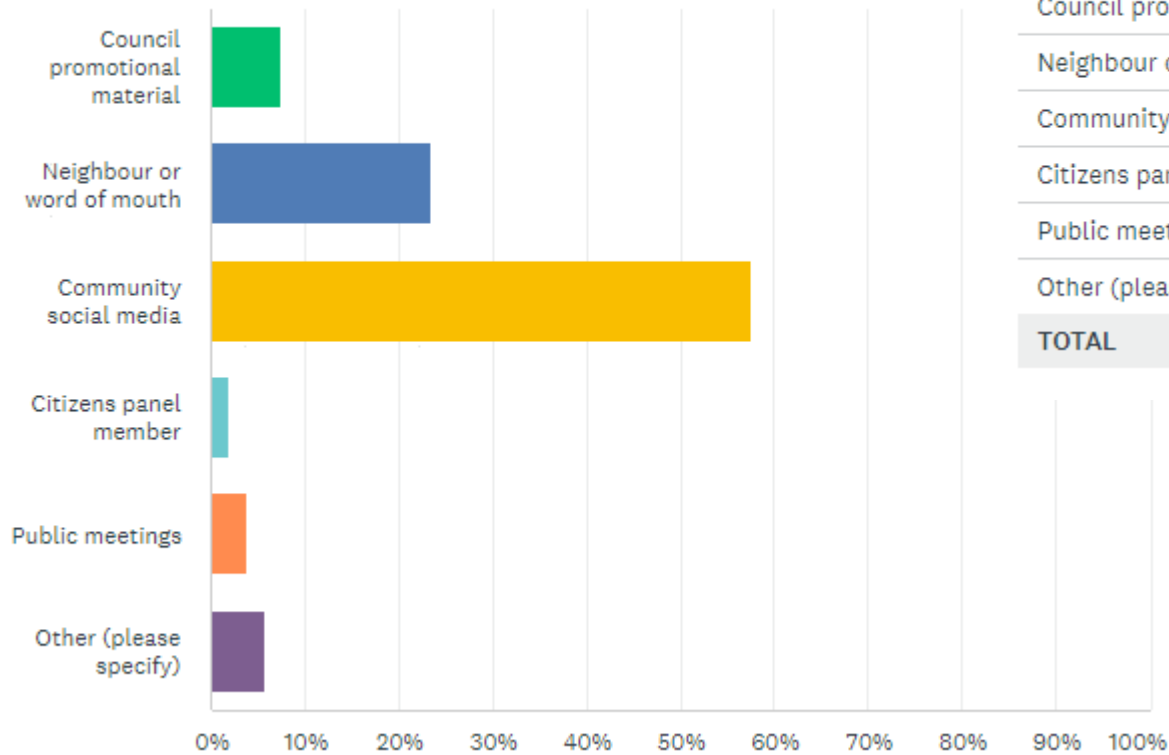

ANSWER CHOICES	RESPONSES
Council promotional material	7.39% 37
Neighbour or word of mouth	23.55% 118
Community social media	57.49% 288
Citizens panel member	2.00% 10
Public meetings	3.79% 19
Other (please specify)	Responses 5.79% 29
TOTAL	501

Q4. We held an initial public launch event at the beginning of February at the Orwell Hotel. Did you attend the first public launch event?

Answered: 501 Skipped: 3

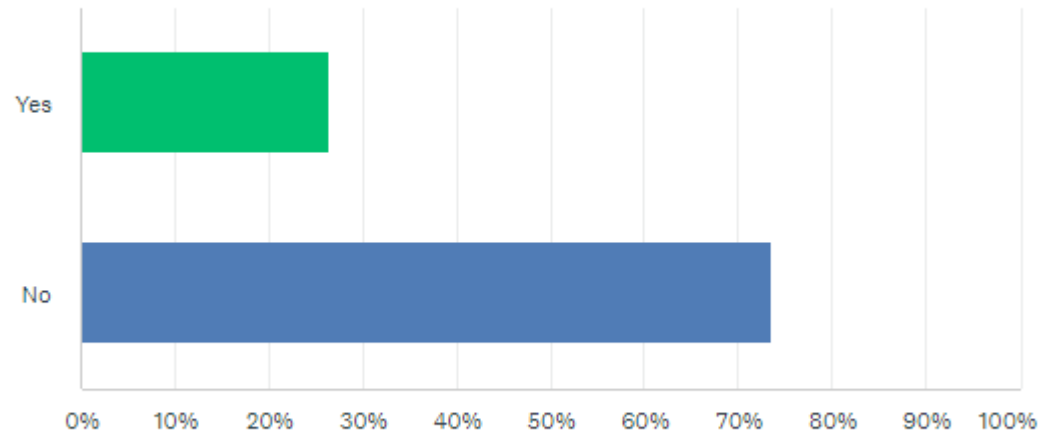

Q5. Have you been involved in workshops for the project eg. citizens panel, online workshops etc?

Answered: 498 Skipped: 6

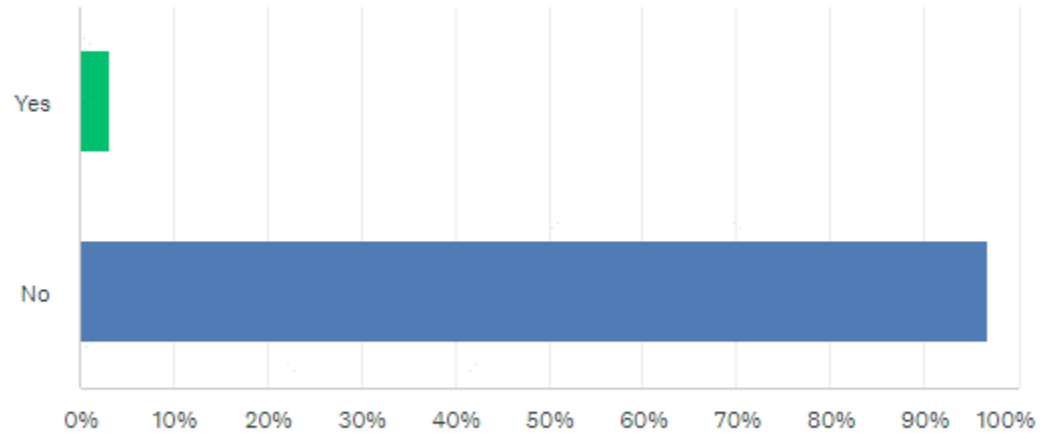

Public Open Space

It is essential that the Garden Neighbourhood includes multi-functional and holistically planned, designed, and managed green spaces.

Delivering areas of natural green space that help to deliver nature recovery, provide environmental resilience from flooding and the effects of climate change, while also providing high quality a recreational environment is at the heart of what we want to achieve.

We are committed to preserving, protecting, and enhancing the sites existing open spaces and important landscape features. For example, the Grove is a valued community asset with biodiversity value and a strong sense of place and identity. Eastward Ho provides important recreational space. However, the quality of the sports pitches and changing facilities at Eastward Ho could be greatly improved.

The new neighbourhood's public open space strategy is set out on consultation boards 7 and 8.

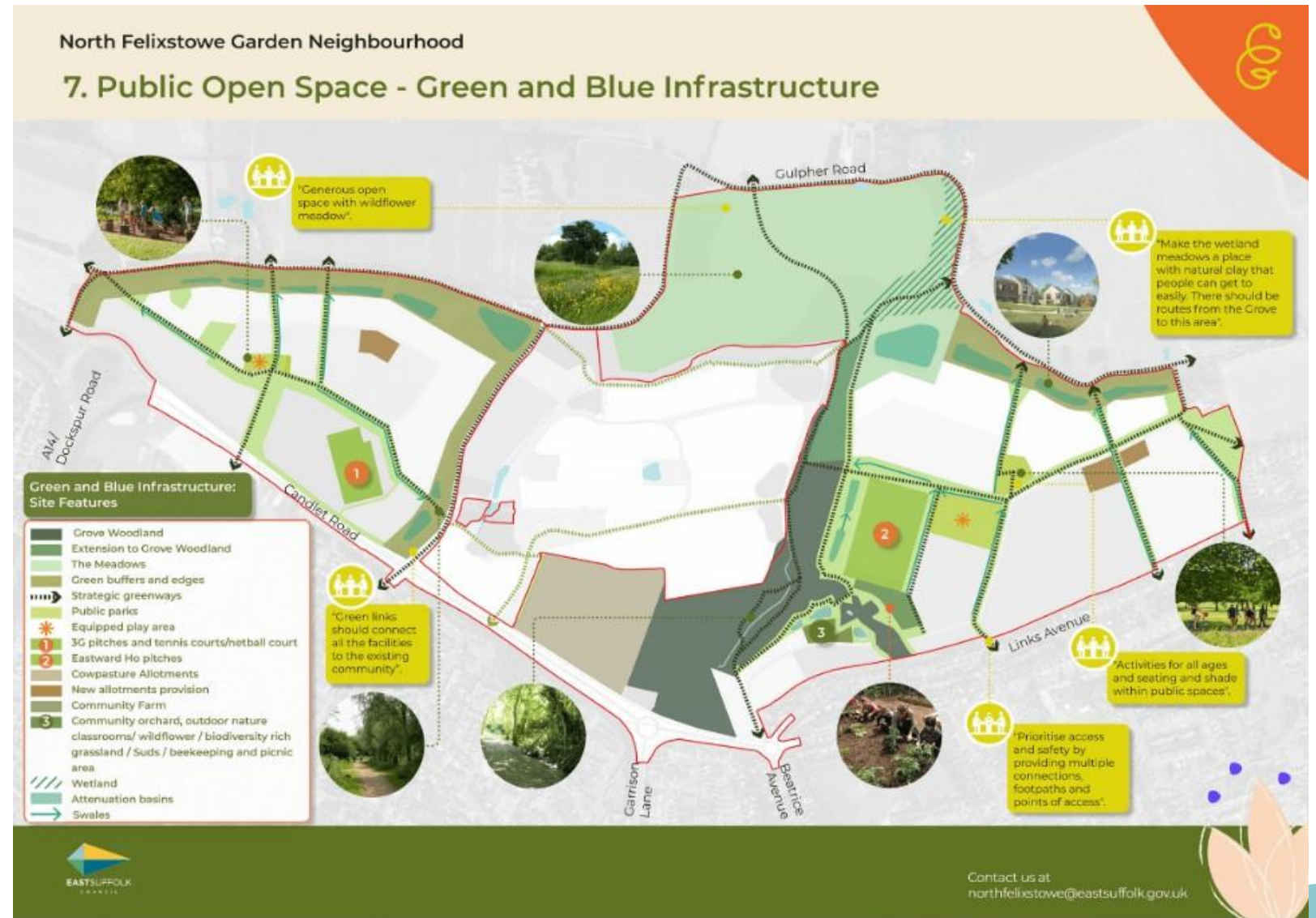

Consultation board 7

A range of community and recreational uses are proposed at Eastward Ho including upgrade to the existing sports pitches and potential for a cricket square, new short track and running loop, new improved equipped play area, improved changing facilities a community farm and new primary school.



Extract from consultation board 8

Q6. Do you think this is an acceptable set of proposals on land at Eastward Ho?

Answered: 500 Skipped: 4

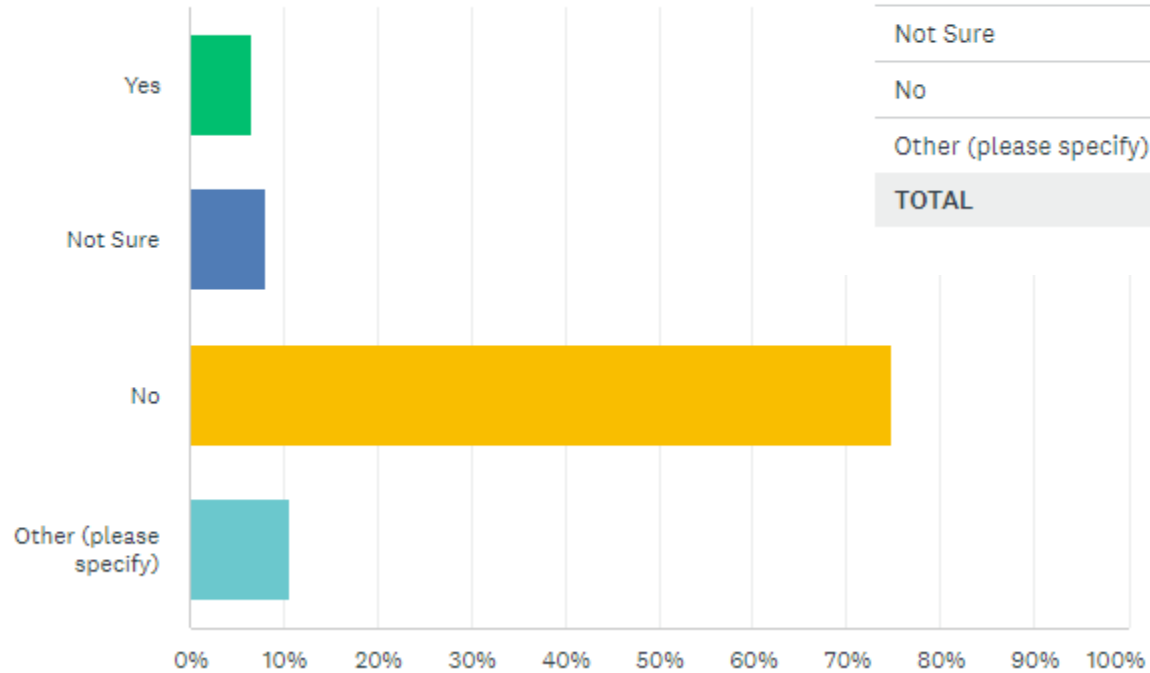

ANSWER CHOICES	RESPONSES
Yes	6.60% 33
Not Sure	8.00% 40
No	74.80% 374
Other (please specify)	10.60% 53
TOTAL	500

Q7. Do you believe the open spaces included in the northern areas of the masterplan could become a valuable asset for Felixstowe by increasing access to natural and semi natural open space?

Answered: 501 Skipped: 3

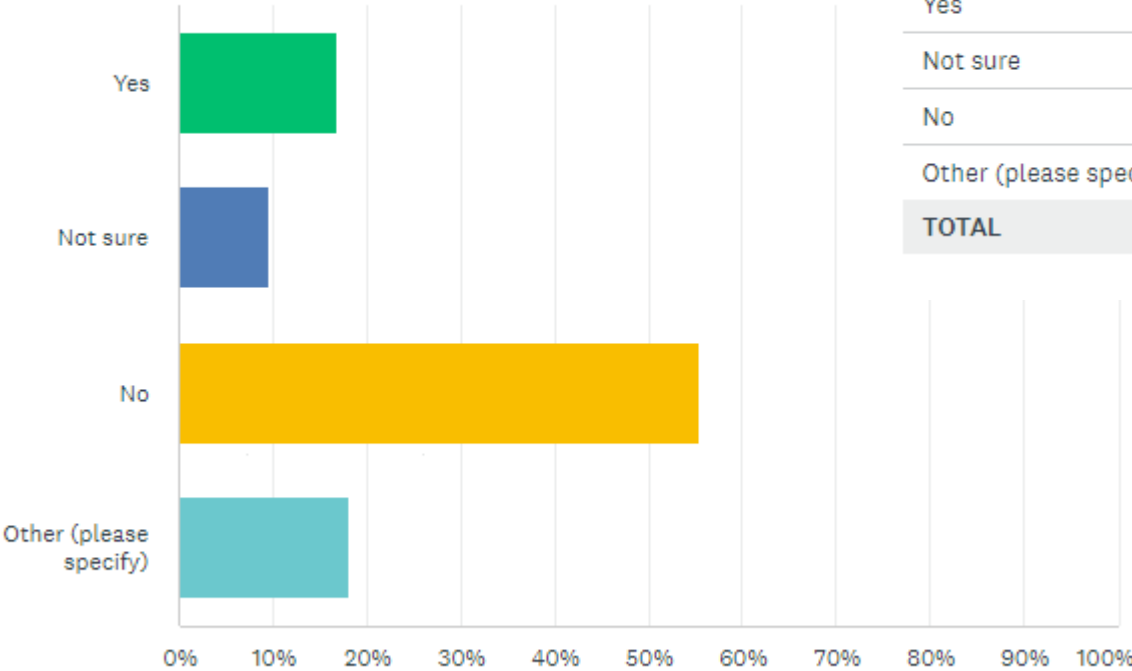

ANSWER CHOICES	RESPONSES
Yes	16.77% 84
Not sure	9.58% 48
No	55.49% 278
Other (please specify)	Responses 18.16% 91
TOTAL	501

The Grove Woodland will be protected and extended northwards with new woodland planting. New sustainable drainage areas will be located between the pitches and the Grove Woodland with biodiverse planting, creating new habitats and an appropriate transition and edge to the woodland. At the southern end of the Grove, close to the medical centre, there is a proposal to create a community orchard closer to the woodland edge and Neighbourhood Hub - perhaps with bee keeping and outdoor nature classrooms.



Consultation board 7

Q8. Do you agree with the proposals as related to The Grove Woodland?

Answered: 503 Skipped: 1

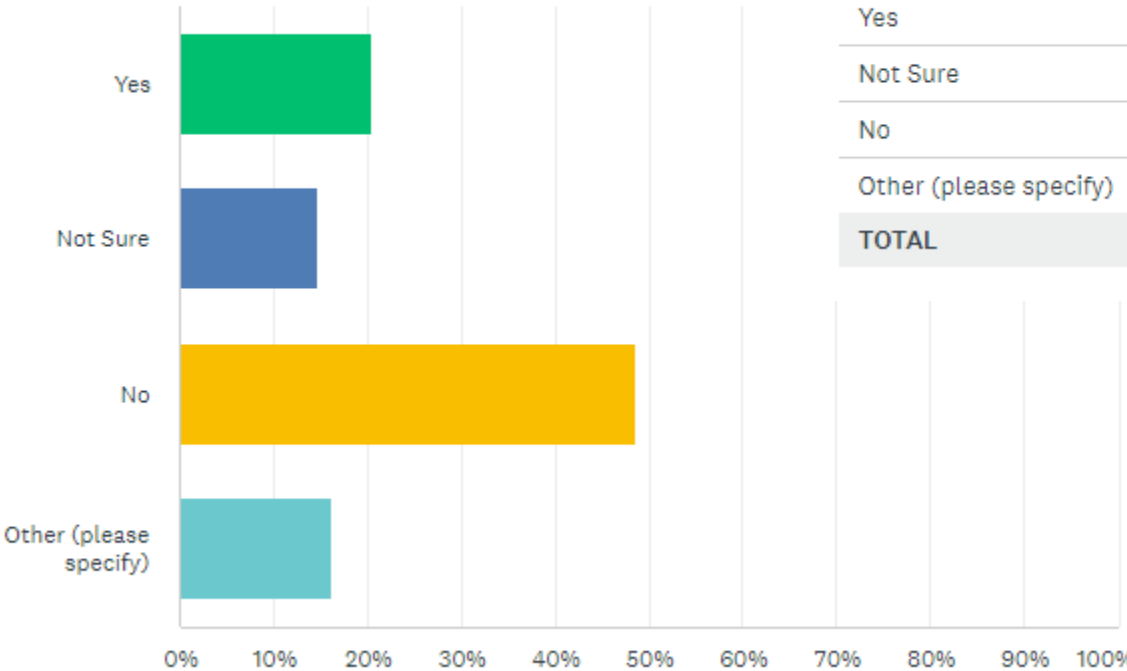

ANSWER CHOICES	RESPONSES
Yes	20.48% 103
Not Sure	14.71% 74
No	48.51% 244
Other (please specify)	16.30% 82
TOTAL	503

Q9. Do you have any other comments on the public open space strategy?

In this open response question three themes emerged and we have presented some sample responses for each below.

Theme 01 - Concern for the natural environment

“Far too frequently we have seen well meaning proposals put forward by development teams only to see them watered down or even dismissed by the house builders in the final housing schemes. Multi use of a specific public space is a difficult thing to manage without specific objectives and recognition of user groups. A few buzz words, like bee hives and wild flower meadows is not seen as a well thought out plan.”

“There is not enough connectivity to any of the proposed new green spaces. The existing woodland is going to be pressured by increased recreation. Cats from the houses on the boundaries of any green space will cause lots of damage. Wildlife and people (often with dogs off leads) don't mix very well. If you are going to extend the Grove you should let areas rewild so you can get transitional scrub and ecotone of the woodland edge as it develops.”

“Your proposals are more likely to reduce biodiversity and introduce a greater monoculture than enhance this precious local asset.”

Theme 02 - Concern for public access to open space and leisure

“Please, please, save Eastward Ho, the plans do not account for community need or desire. I saw the council say that the proposed school would take up a small portion of the land but this is simply untrue. It is so upsetting that you have ploughed ahead with this proposal despite such public outcry. It's like you're not listening to the people of Felixstowe at all.”

“My concern is primarily Eastward Ho. Losing the playing fields for a primary school seems unnecessary. Also the fields being kept for the public there become waterlogged and sometimes impassable in heavy rain so although it may look like a fair division we're losing a lot more for the wetter months.”

Q9. Do you have any other comments on the public open space strategy? Continued...

Theme 03 - Concern for local infrastructure and that there is too much development locally

“There are enough new housing developments within Felixstowe and surrounding areas without the need for further houses and the impact this has on a peninsular town with sea and rivers on 3 sides. Decreasing any green space will have a negative impact. More housing and empty promises won't improve the area we live in. More people without anything to do, increase traffic on one main road in and out, increase sewage, water demands. Saying a new doctors school extra will be built doesn't mean you will get people to staff them. Not enough dentists or decent schools here already, town centre uninspiring, no decent leisure facilities or enough local jobs.”

“Too many houses are proposed for the Felixstowe peninsula without improvements to policing fire service and hospital. Road system will be inadequate for the amount of housing with just the one road in and out. traffic on Beatrice Avenue and Ferry Road will be a nightmare and an increased danger especially at school drop-off and pick-up time. We can ill afford to lose any more grade-A farmland and the effect of wildlife is already immense from the recent builds. ANY WALKING AND CYCLE ROUTES WILL NOT BE COUNTRYSIDE BUT IN BUILT UP AND HEAVY TRAFFIC AREAS”

“Eastward Ho playing fields and open space in their current size should be maintained and improved because it is used for multiple events and provides a wonderful green space for mental health. There should be NO building works in the green spaces that surround The Grove, which include the horse paddocks because it will destroy the wildlife and their habitats.”

“Building more houses on the Grove area will bring no value to our community. By increasing the number of new build areas we will end up like Ipswich, where all the new build developments have destroyed the culture of Ipswich, and created smaller shopping areas which have ruined the town centre. When creating new build areas the council must consider whether the benefit of building in that area will provide greater value than what exists there already. The Grove is the most popular free space in the area for sports, dog walking and play. A better way to bring benefits and value would be to improve the park and play facilities. This could bring in more tourism.”

Active travel and connectivity

The new neighbourhoods active travel and connectivity strategy is set out on boards 9 and 10.

The North Felixstowe Garden Neighbourhood will be designed so that movement is easy, safe, and convenient.



We are aware of the challenges that Candlet Road presents and we have therefore developed a movement strategy to address these issues, including:

- New ground level pedestrian and cycle crossing of Candlet Road at the junction with Walton North.
- Improved pedestrian and cycle crossing underneath Candlet Road via Gulpher Road.
- New shared footpath and cycle path along the northern edge of Candlet Road, extending the existing route at Trelawny Place up to the new Walton North roundabout.
- Planting along the northern edges of Candlet Road to minimise the impact on the new Leisure Centre and housing
- Provision of a planted embankment to the west of the Walton North junction where the speed limits are higher and there is already a significant change in level.
- Potential reduction in speed limit from 40mph to 30mph east of Walton North junction.

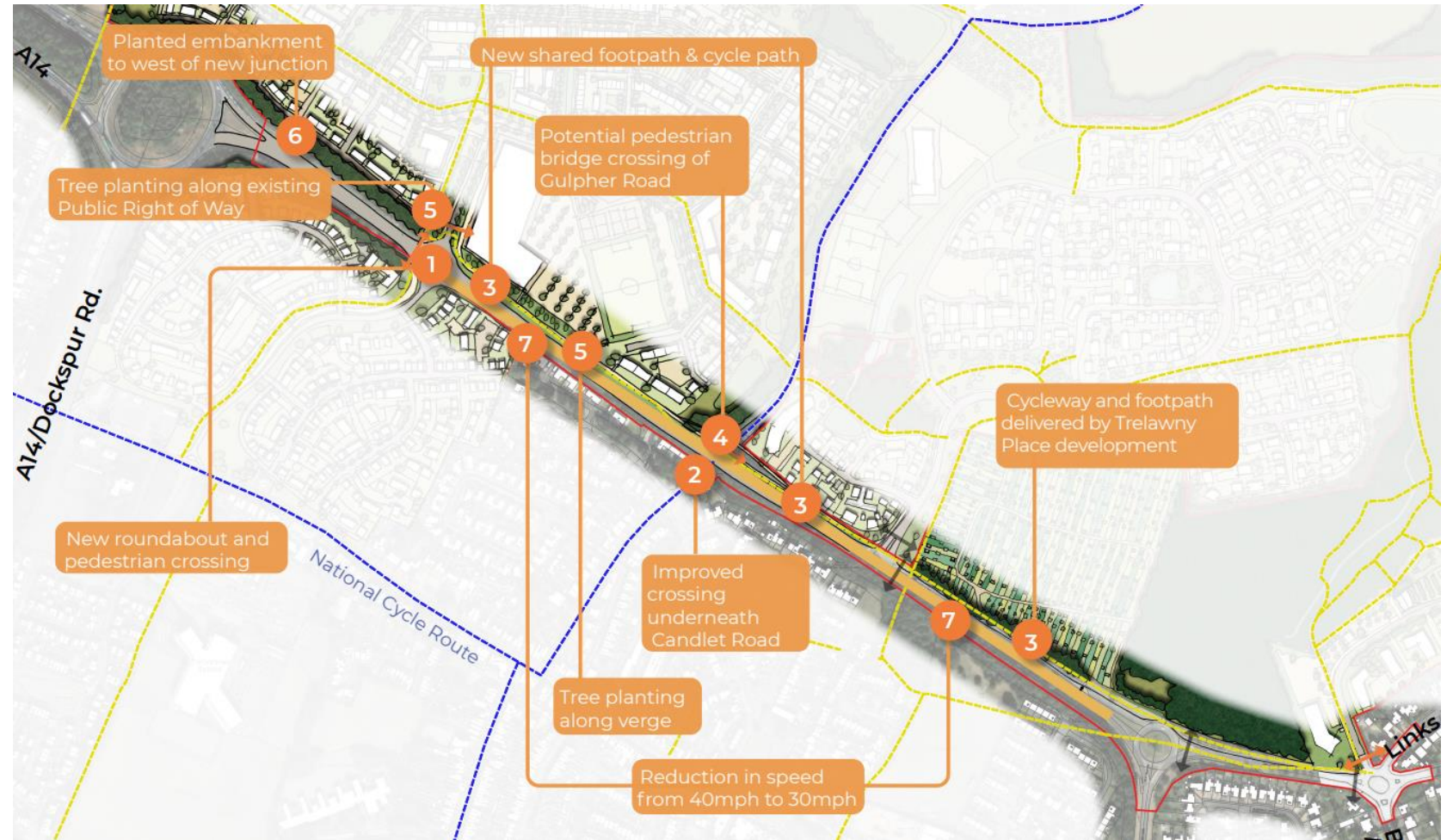

Extract from consultation board 10

Q10. Do you believe the above strategy adequately addresses the challenges of Candlet Road and will help create the right connections into the existing town?

Answered: 501 Skipped: 3

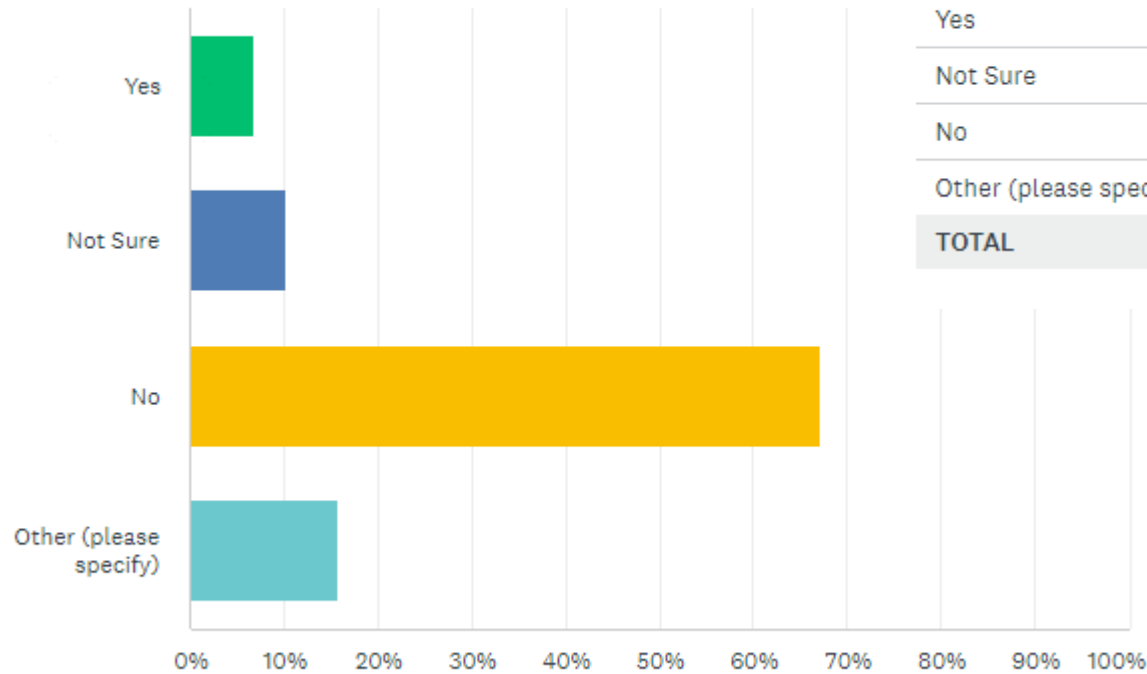

ANSWER CHOICES	RESPONSES
Yes	6.79% 34
Not Sure	10.18% 51
No	67.27% 337
Other (please specify)	Responses 15.77% 79
TOTAL	501

The neighbourhood will contain a large number of dedicated walking and cycling routes. These routes will connect homes in north Felixstowe to nearby community facilities, as well the countryside to the north and the existing town to the south with approximately 3.1km of new strategic footpaths and cycle paths.

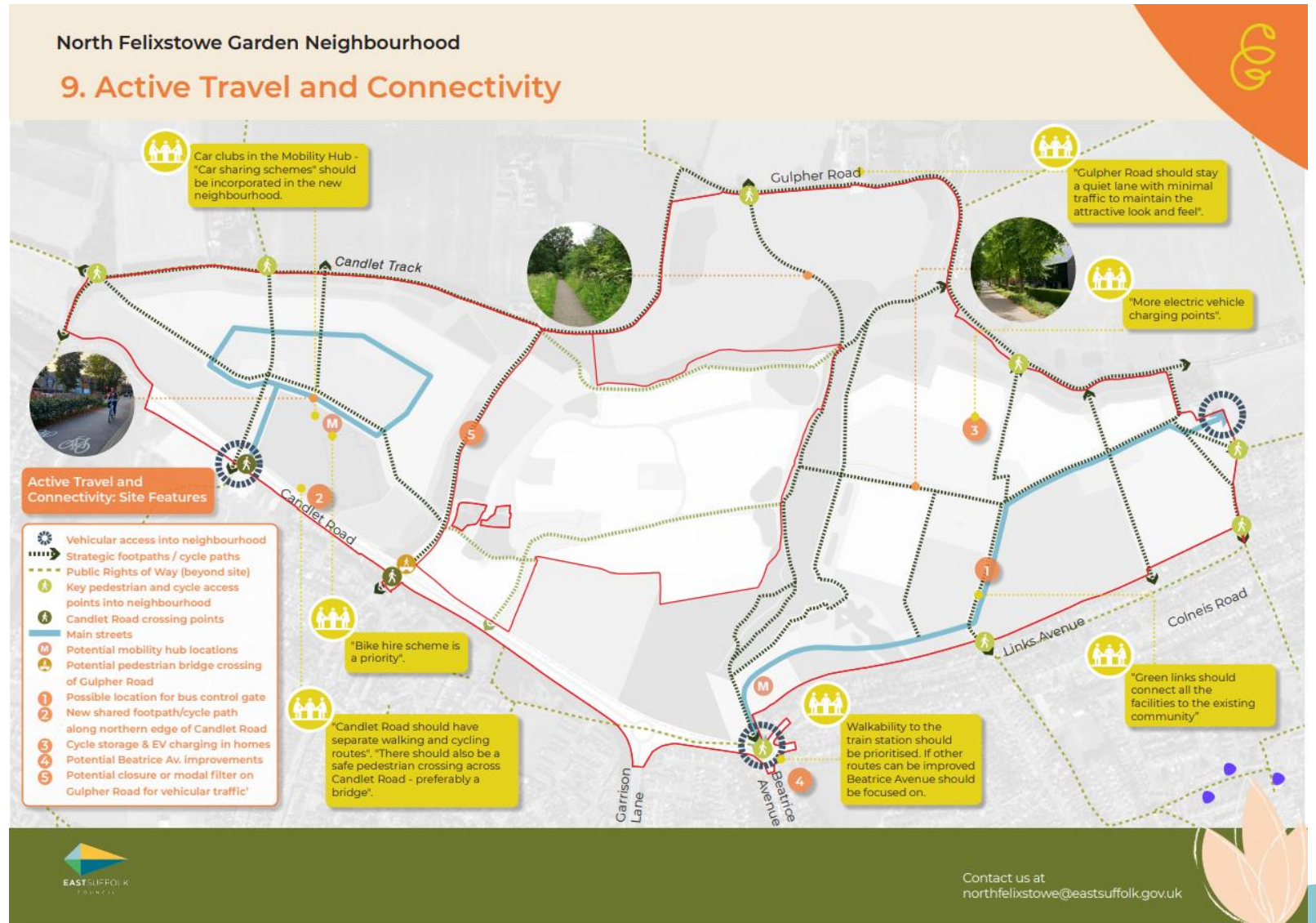

Q11. Do you believe the new strategic footpaths and cycle paths will help connect the new neighbourhood with the existing town and landscape to the north and could become a valuable asset for Felixstowe?

Answered: 502 Skipped: 2

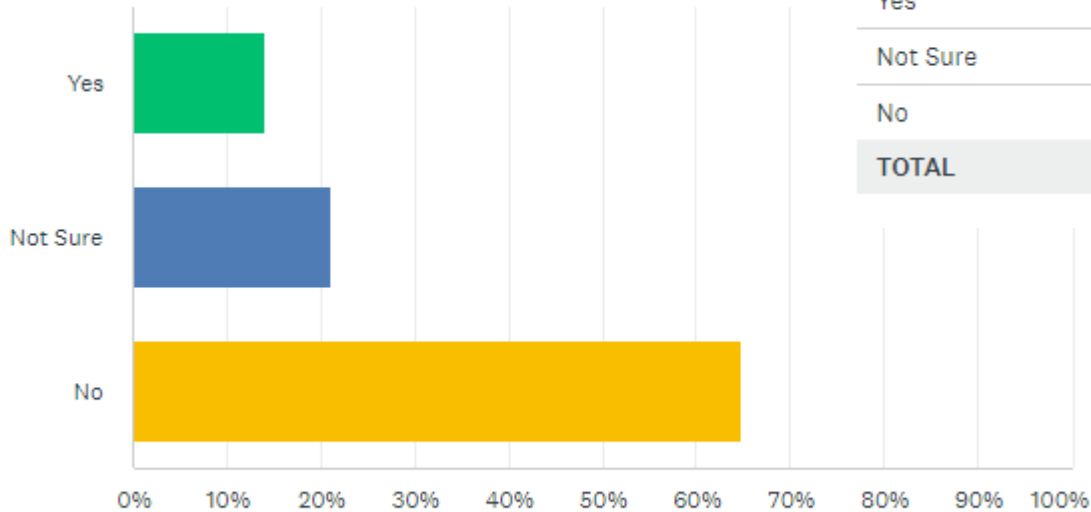

ANSWER CHOICES	RESPONSES
Yes	14.14% 71
Not Sure	21.12% 106
No	64.74% 325
TOTAL	502

Many members of the community have expressed their desire to protect Gulpher Road and its rural character which is reinforced by its Quiet Lanes designation.

We have been clear that we have never proposed any access points to the masterplan off Gulpher Road and we are looking to protect and enhance Gulpher Road for walking and cycling.

Although some vehicle traffic will always be required for access, we are considering proposing potential closure or a modal filter on Gulpher Road to allow walking, cycling, and riding but preventing vehicular traffic.



Q12. Would you be in favour of limiting vehicular traffic on Gulpher Road?

Answered: 501 Skipped: 3

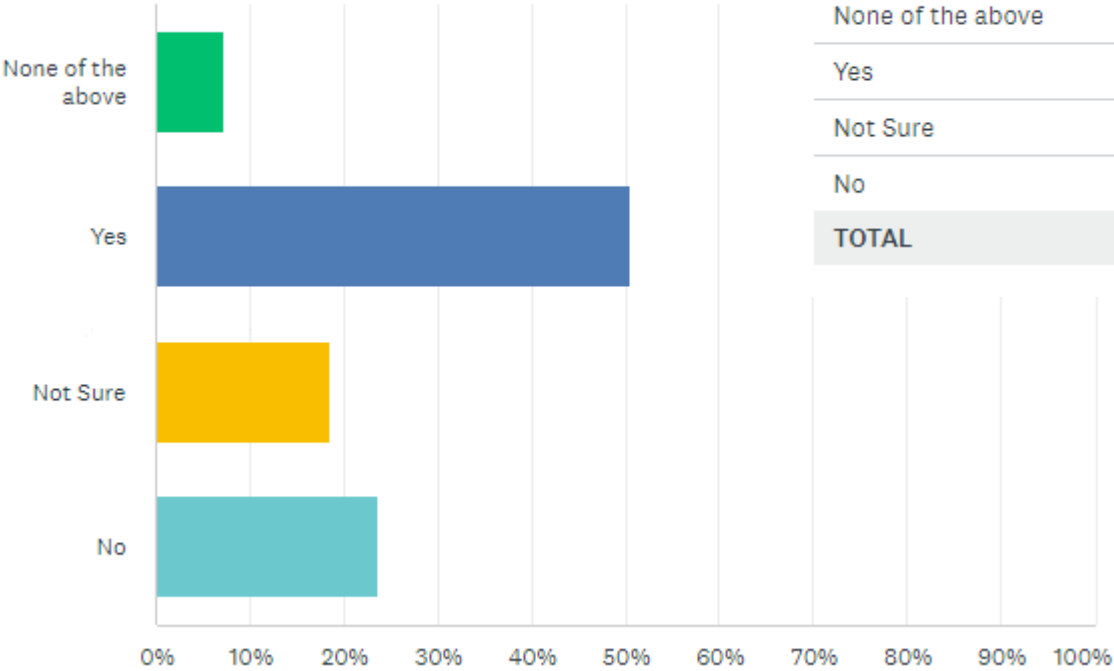

ANSWER CHOICES	RESPONSES
None of the above	7.19% 36
Yes	50.50% 253
Not Sure	18.56% 93
No	23.75% 119
TOTAL	501

Another offsite route which we believe will be key in connecting the new neighbourhood into Felixstowe is Beatrice Avenue. It is the most direct route from the station and town centre to the masterplan site which makes it an important route to consider, particularly for walking and cycling.



Q13. Would you like to see improvements made to Beatrice Avenue to help connect the masterplan site to the existing town?

Answered: 500 Skipped: 4

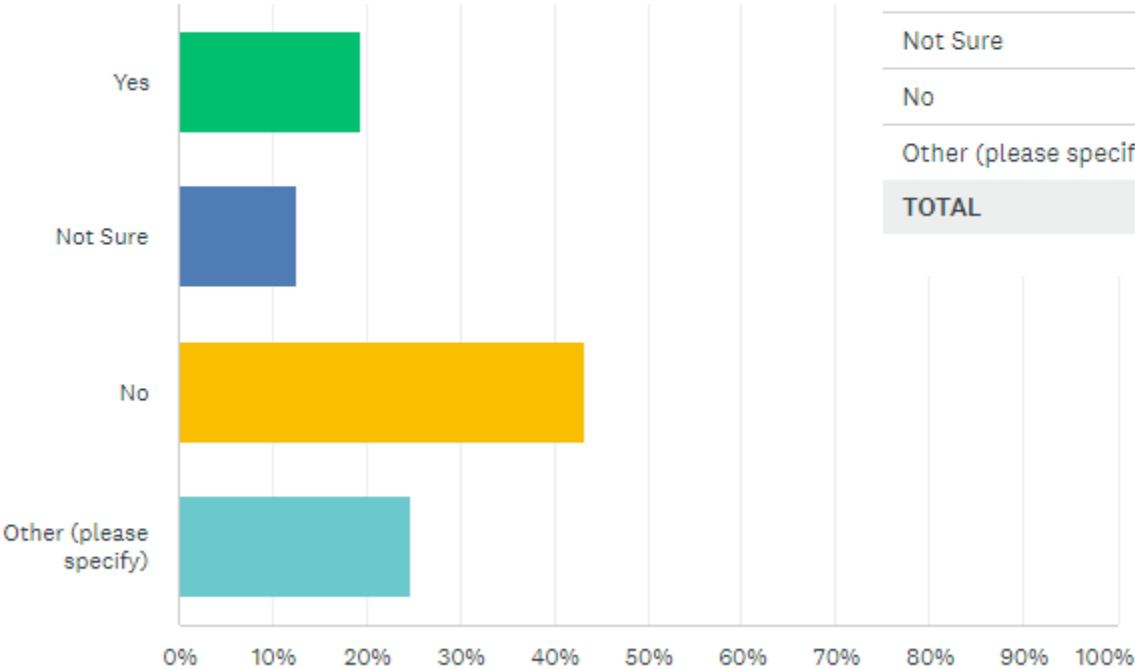

ANSWER CHOICES	RESPONSES
Yes	19.40% 97
Not Sure	12.60% 63
No	43.20% 216
Other (please specify)	24.80% 124
TOTAL	500

Placemaking and identity

The new neighbourhood proposals with regard to placemaking and identity is set out on boards 12 and 13.

Throughout the entire development, The North Felixstowe Garden Neighbourhood will take a 'whole town' perspective meaning its uses and identity will seamlessly integrate with the existing town, and the surrounding environment.

It has always been a priority for the project team to ensure seamless integration with the existing town and the local centres will be a critical part of this. We cannot be too explicit about exactly what will come forward at this point however we are trying to ensure the design will allow for the inclusion of the below uses.

North Felixstowe Garden Neighbourhood

5. Draft Framework Masterplan and Key Concepts



Framework Masterplan Legend:

	Site application boundary
	Residential 30dph (dwellings per hectare)
	Residential 35dph
	Residential 40dph
	Residential 45dph
	Residential 50dph
	Retirement Living 37dph
	Leisure Centre including cafe and satellite GP
	Neighbourhood hub including existing medical centre
	Community Farm
	Employment
	Primary School (2 classes per year group)
	Community
	Convenience store, retail and residential
	Existing woodland
	Proposed woodland
	Proposed wetlands and drainage
	Parks, amenity and equipped play
	3G pitches and tennis courts/netball court
	Pitches
	Equipped play areas
	Natural and Semi-Natural green space
	Allotments
	Existing retained hedgerows
	Historic field boundary alignment
	Existing watercourses
	Acoustic bank
	Primary streets
	Strategic footpaths/cycleway

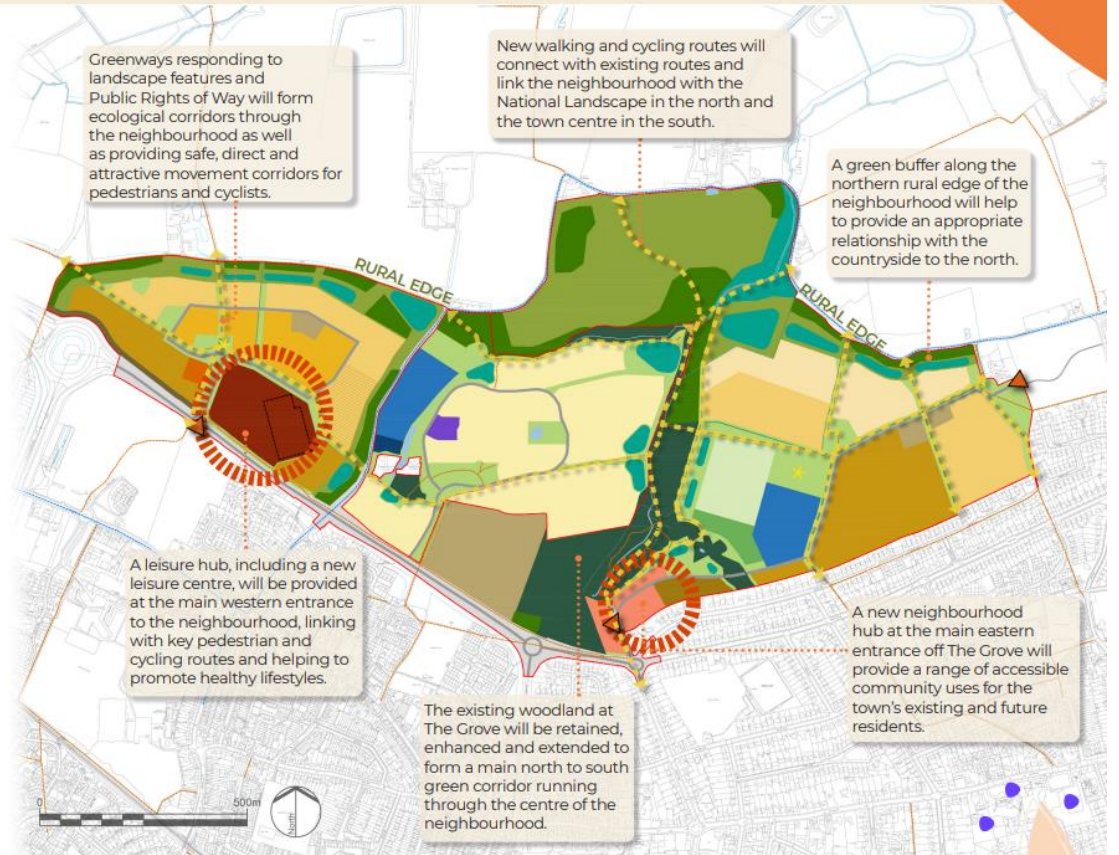

Contact us at
northfelixstowe@eastsuffolk.gov.uk

A new neighbourhood hub at the main eastern entrance off The Grove will provide a range of accessible community uses for the town's existing and future residents. Local centre uses could include:

- Woodland café / visitor centre
- Farm shop / sports pavilion / changing facilities
- Mobility hub (locations where people can access multiple types of transportation modes eg. Car share, bike hire, public transit, micro mobility devices)
- Community hall
- Residential units
- Community farm
- Retail
- Pub
- Nursery
- Work hub (co-working space where meeting rooms and small office spaces can be hired on short term basis)



Extract from consultation board 13

A leisure hub, including a new leisure centre, will be provided at the main western entrance to the neighbourhood, linking with key pedestrian and cycling routes and helping to promote healthy lifestyles. Local centre uses could include:

- Mobility hub (locations where people can access multiple types of transportation modes eg. Car share, bike hire, public transit, micro mobility devices)
- Residential
- Retail
- Nursery
- Work hub (co-working space where meeting rooms and small office spaces can be hired on short term basis)
- Satellite GP
- Café

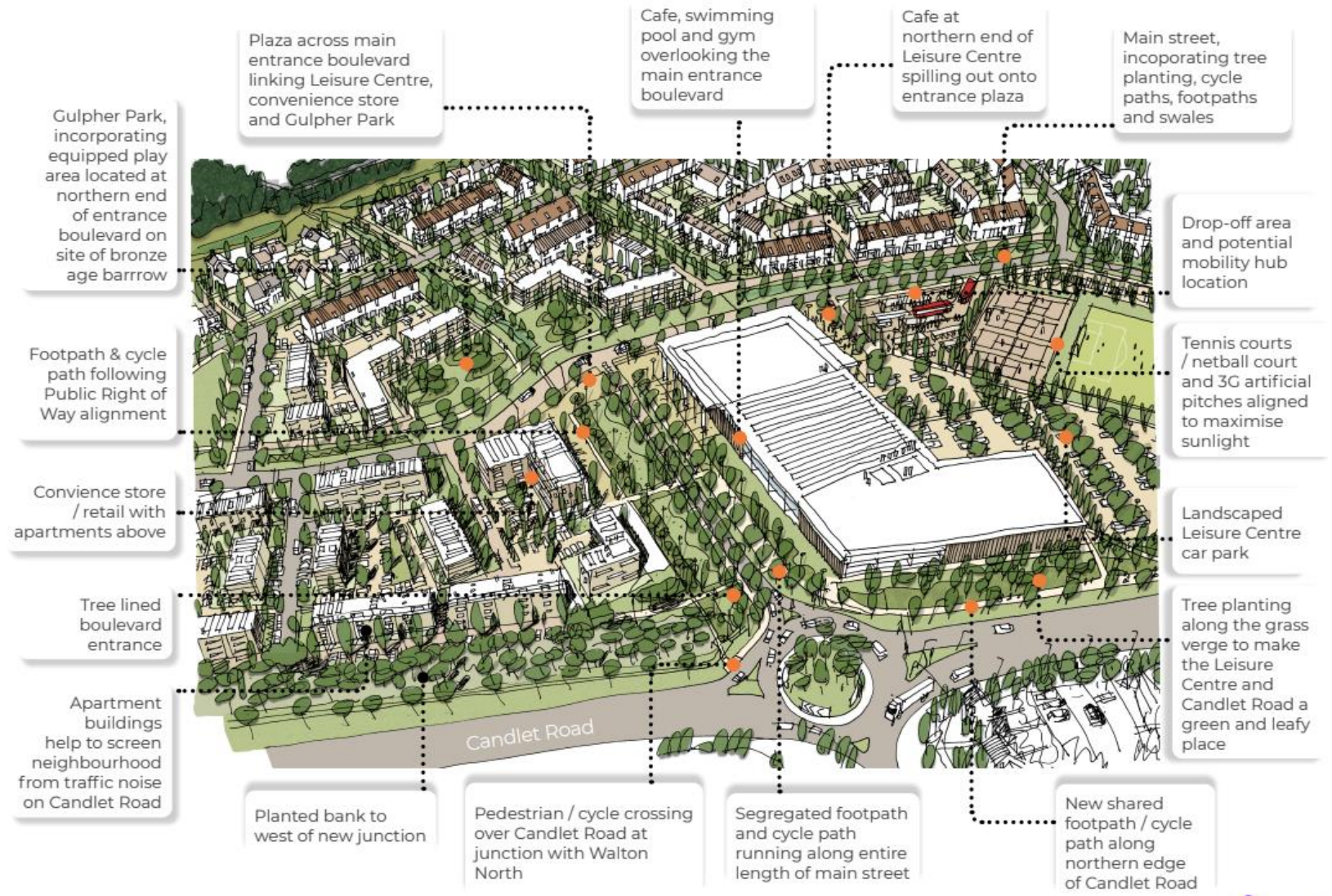

Extract from consultation board 12

Q14. Do you think the above uses would benefit Felixstowe?

Answered: 498 Skipped: 6

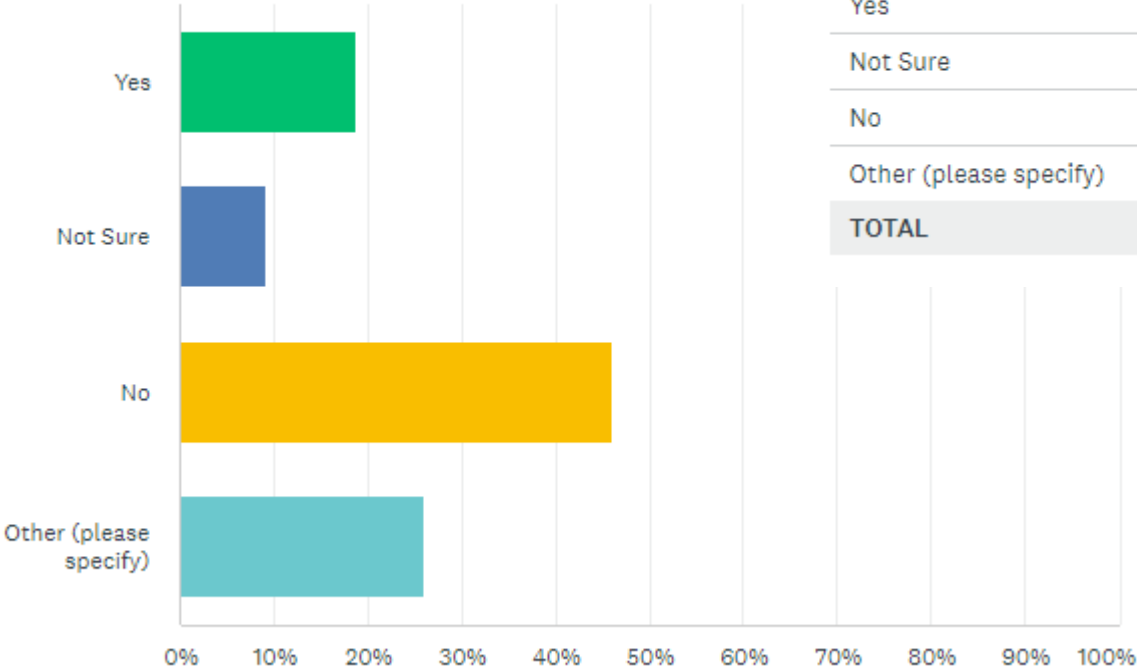

ANSWER CHOICES	RESPONSES	
Yes	18.67%	93
Not Sure	9.24%	46
No	45.98%	229
Other (please specify)	Responses 26.10%	130
TOTAL		498

Q15. Are there any other facilities or services that are missing which you think would complement the local centres?

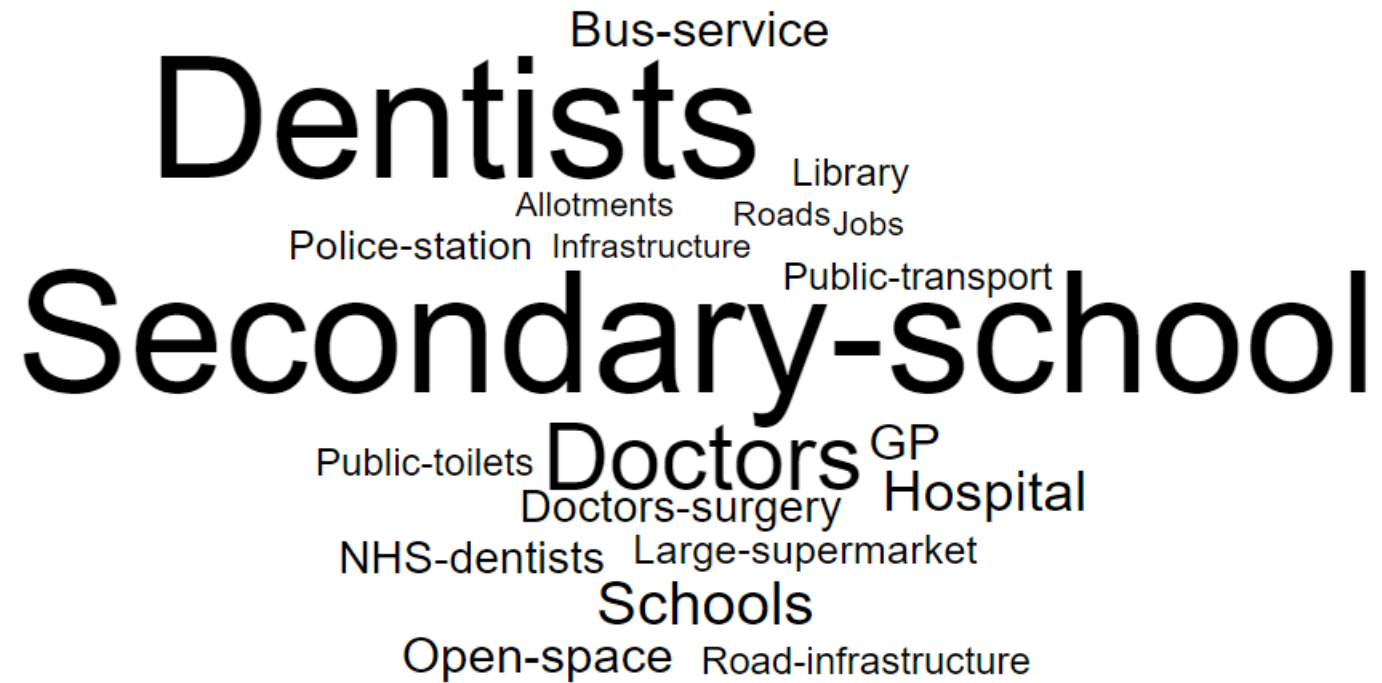

*minimum frequency 2

Q16. What are the most important sustainability issues that need to be addressed by the North Felixstowe Garden Neighbourhood?

In this open response question three themes emerged and we have presented some sample responses for each below.

Theme 01 - Concern that the development should be ambitious in terms of quality of build and sustainable credentials including transportation

“Is there any requirement for the buildings to have at least 50% renewable energy sources? What minimum level of energy performance certificate is required for all the buildings? I can not believe I am filling in a form talking about sustainability, carbon reductions, climate resilience when you are planning on building on open land which supports a wide range of wildlife and biodiversity. The houses already built in Walton and Trimley are not selling and yet you want more built.”

“This is our opportunity to be really ambitious with regard to sustainable travel and responding to the climate emergency. All new properties should have solar panels. Walking/cycling & use of electric scooters needs to be prioritised alongside cheap frequent accessible public transport for all of Felixstowe. The plans for Eastward Ho are mainly very structured. We would welcome more less structured open space which would be better for wildlife”

“For the houses to be built with heat pumps and solar panels. Adequate gardens for families. Roads wide enough for vehicles to pass each other. An abundance of trees within these estates and green areas. This would help climate change not houses so close together there is no room to park cars. Properties need sufficient car parking for all the family and residents.”

Theme 02 - Concern for natural environment

“Lack of nature - building on the only accessible open green space that is available to the residents of Felixstowe. There is so much research available about the health and mental benefits to people who can get into open green space. We are going to have to go much further to get beyond housing into 'proper countryside', this cannot be anything other than bad. Homes are planned to be built on an area which already floods - without the expected future increase in flooding (sea and rainfall). There is inadequate provision for treatment of sewage and much potential for more to be discharged into the Deben, risking the blue flag status of Felixstowe. Building homes so close to our ancient woodland will be catastrophic to wildlife.”

“NOT BUILDING IT IN THE FIRST PLACE!”

Q16. What are the most important sustainability issues that need to be addressed by the North Felixstowe Garden Neighbourhood? Continued...

Theme 03 - Concern for local infrastructure and that there is too much development locally

“It would be nice to think that the new development would promote sustainability, however with the number of new residential units, all of which would come with 1 to 2 cars, as have all of the other new developments in Felixstowe, despite public transport and walking routes being in place. This will ultimately create more traffic and a higher carbon footprint for Felixstowe.”

“No more building!!! There is not enough doctors, dentist's or road infrastructure!!!”

“Nothing has been mentioned about infrastructure. There will be too much pressure placed on Candlet Road. I feel another /additional route needs adding. The only mention made about cars in this development is to ‘car share’. This will just not happen. People of Felixstowe will just not consider it. More houses means more people which means more cars. You need to provide a better improved road system if this development is to happen.”

“Not building on the land! The list of sustainability themes is simply words. The minute you start building, you are increasing the carbon footprint of the town in every way - and destroying nature, certainly not encouraging its ‘abundance’.”

“These plans are reducing space for nature, increasing pollution with housing and traffic which will be backlogged trying to exit Felixstowe but stuck in traffic jams. Building will increase flooding with water not being able to go into the ground.”